

SC-KD3



**3 METRE
SICAK DALDIRMA**

GALVANİZ KAPLI KAMERA DİREĞİ



Teknik Özellikler

Alt Gövde Çapı	: 101 mm
Alt Gövde Uzunluğu	: 50 cm
Üst Gövde Çapı	: 76mm
Üst Gövde Uzunluğu	: 2.5 m
Gövde Kalınlığı	: 2 mm
Rüzgara Dayanıklılık	: 90 km/h
Taban Plakası	: 8 mm x 200 mm x 200 mm
Direk Temeli	: 3 x M12 Ankraj - Ankraj Dik Boyu : 390 mm - Ankraj Toplam Boyu : 432 mm



Technical Specifications

Lower Body Diameter	: 101 mm
Lower Body Length	: 50 cm
Upper Body Diameter	: 76mm
Upper Body Length	: 2.5 mm
Body Thickness	: 2 mm
Wind Durability	: 90 km/h
Base Plate	: 8 mm x 200 mm x 200 mm
Pole foundation	: 3 x M12 Anchor - Anchor Vertical Height : 390 mm - Anchor Total Length : 432 mm

Levha Standardı
Plate Standart
EN10025

Üretim
Standardı
Production
Standart
EN40-5

Galvanizleme
Standardı
Galvanising
Standart
TSE EN 1461

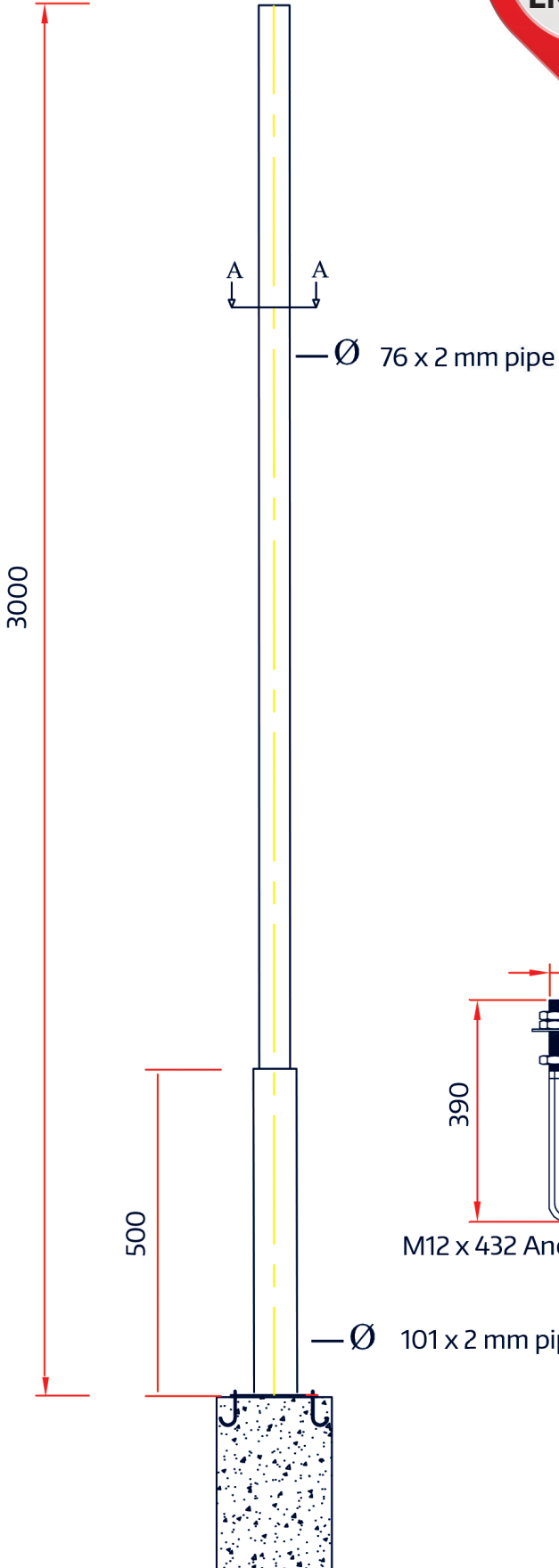

A - A Section

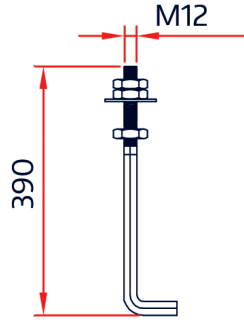

M12 x 432 Anchor Bolts ... 3 pcs

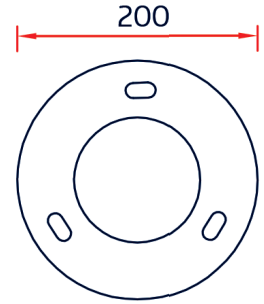

BASE PLATE

8 mm x 200 x 200